

# **DIRECTIONS FOR EARLY LS OIL FILTER ADAPTER KIT**

**CLEAR VIEW FILTRATION'S ADAPTERS, THREAD ONTO THE BLOCK WHERE THE STOCK DISPOSABLE OIL FILTER USUALLY GOES. THESE ADAPTERS ADAPT THE BLOCKS STOCK OIL FILTER OUTLET AND INLET OIL FEED HOLES TO FLOW THROUGH THREADED #12 OPENINGS IN THE BILLET ADAPTERS. ADAPTERS THREAD ON REPLACING THE DISPOSABLE FILTER. HEX NUT MACHINED INTO BLOCK ADAPTER FOR EASY INSTALLATION OR REMOVAL. YOU CAN ALSO INSTALL THE CENTER FITTING AND USE A SOCKET TO INSTAL THE ADAPTER TO THE BLOCK.**

**THIS IS VERY IMPORTANT, IF INSTALLED WRONG IT COULD RESTRICT OIL FLOW AND DAMAGE THE ENGINE !!!** THE INLET AND OUTLET OPENINGS ARE ENGRAVED IN AND OUT. TO HOOK UP THE OIL LINES CORRECTLY, THE OUT OR OUTLET OPENING NEEDS TO BE HOOKED TO THE IN OR INLET OPENING OF THE REMOTE FILTER. THEN HOOK THE OUT OR OUTLET OF THE REMOTE FILTER TO THE IN OR INLET OPENING OF THE BLOCK ADAPTER. **LOOK UP THE DISPOSABLE FILTER FOR APPLICATION TO MAKE SURE THE THREAD SIZE MATCHES THE ADAPTER**

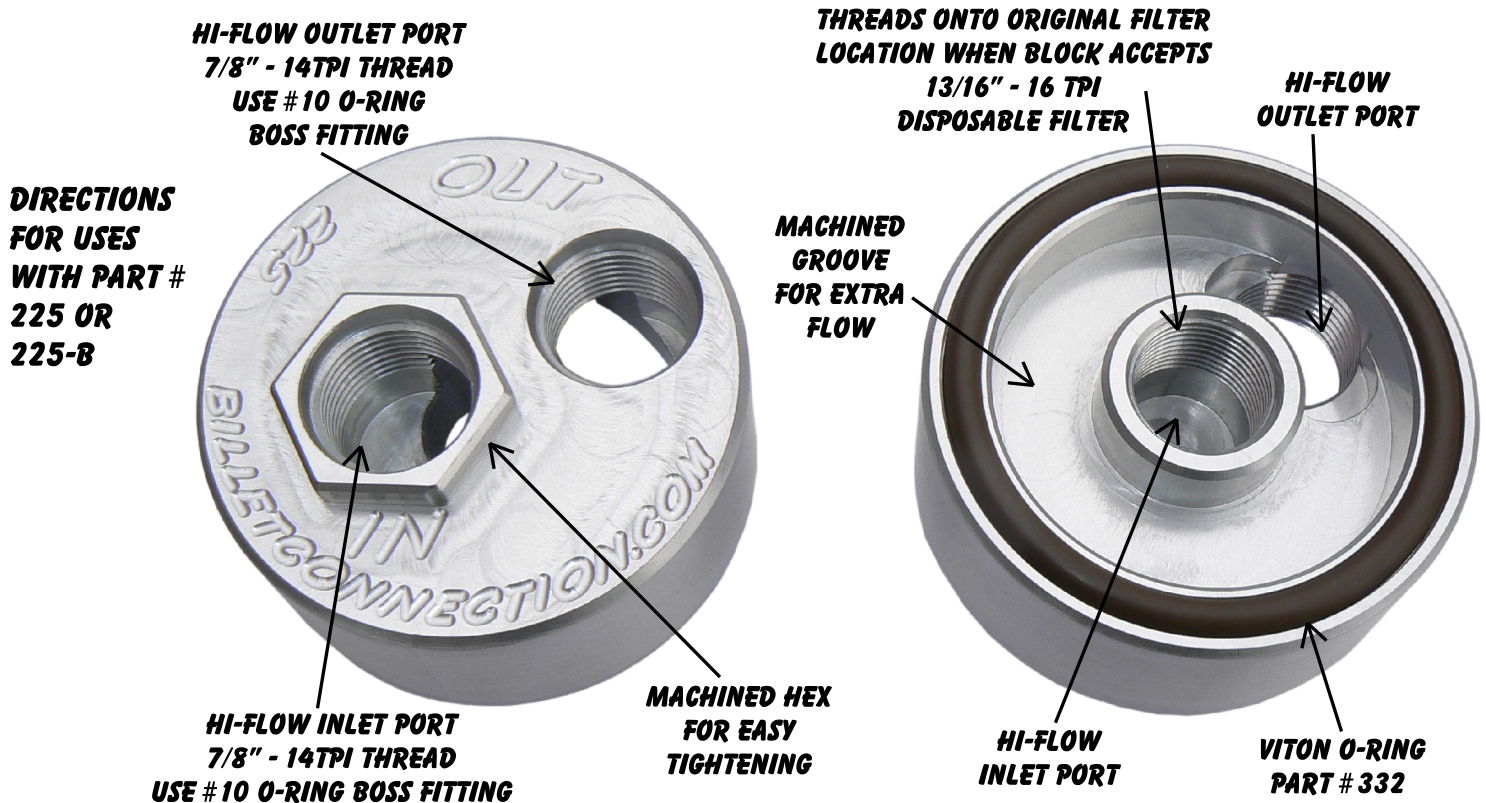

**THE BLOCK ADAPTERS INLET AND OUTLET OPENINGS ARE THREADED TO 7/8" - 14 THREADS PER INCH, THIS THREAD USES A FITTING CALLED A #10 O-RING BOSS ON THE END THAT THREADS INTO THE BLOCK ADAPTER, THE OTHER END COMES IN DIFFERENT STYLES OF FITTINGS INCLUDING # 8 OR #12 IF THIS IS THE SIZE OF LINE WANTED TO BE USED.**

**RECOMMENDED FITTING FOR BLOCK ADAPTERS A #10 O-RING BOSS TO A #10 JIC MALE FITTING.** THIS FITTING HAS THE SAME INSIDE DIAMETER THAT AN ENGINE HAS FOR OIL INLET & OUTLET PASSAGES. THIS FITTING WILL NOT RESTRICT OIL FLOW.

**PART # 225 AND 225-B ACCEPTS DISPOSABLE FILTER THREAD SIZE: 13/16" X 16 TPI**

**MAKE SURE TO OIL ALL O-RINGS ON THE BLOCK ADAPTER AND FITTINGS BEFORE INSTALL.**

**REPLACEMENT O-RING KIT AVAILABLE FOR THESE BLOCK ADAPTERS. O-RING KIT PART # 211.**

**CLEAR VIEW FILTRATION ALSO CARRIES FITTINGS, O-RINGS KITS AND FASTENERS NEEDED FOR THE CHEVY BLOCK ADAPTERS. CHECK OUT OUR WEBSITE AT [CLEARVIEWFILTRATION.COM](http://CLEARVIEWFILTRATION.COM) FOR MORE PRODUCTS AND INFORMATION.**